

£210,000  
**Towerpoint**  
Enfield, EN2 6SZ

EPC RATING: COUNCIL TAX BAND: E

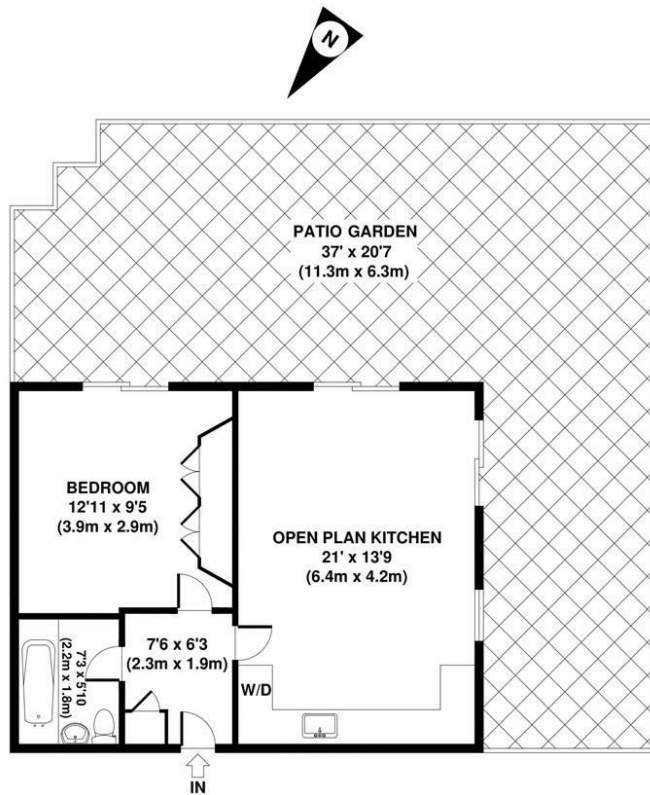

GROSS INTERNAL FLOOR AREA 543 SQ FT

APPROX. GROSS INTERNAL FLOOR AREA 543 SQ FT / 50 SQ M  
Floorplans are for identification and guideline purposes only, not to scale.  
Compliant with RICS code of measuring practice.  
Floorplans supplied by [www.draftingfloorplan.com](http://www.draftingfloorplan.com)

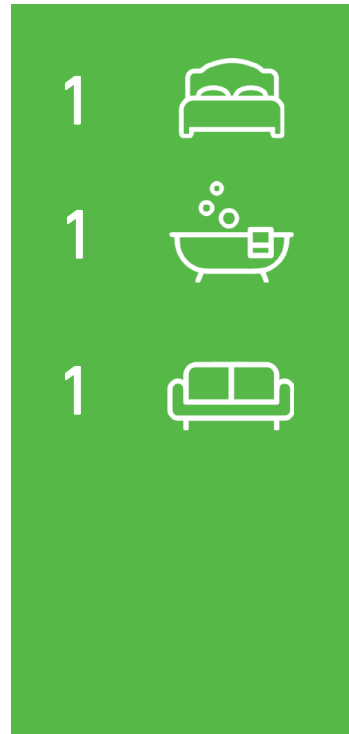

Energy Efficiency Rating		Current	Potential
Very energy efficient - lower running costs			
(92 plus)	<b>A</b>		
(81-91)	<b>B</b>		
(69-80)	<b>C</b>		
(55-68)	<b>D</b>		
(39-54)	<b>E</b>		
(21-38)	<b>F</b>		
(1-20)	<b>G</b>		
Not energy efficient - higher running costs			
<b>England &amp; Wales</b>		EU Directive 2002/91/EC	



Agents Note: Whilst every care has been taken to prepare these particulars, they are for guidance purposes only. All measurements are approximate and are for general guidance purposes only and whilst every care has been taken to ensure their accuracy, they should not be relied upon and potential buyers/tenants are advised to recheck the measurements

**Paul Simon**  
Estate agents

**OFFICE ADDRESS**  
786-788 Green Lanes  
London  
N21 3RE

**OFFICE DETAILS**  
0208 800 1155  
[management@paul-simon.co.uk](mailto:management@paul-simon.co.uk)